

BUILDING REGULATIONS

rev	description	date
drawn	Paul McGuire	04/01/21

Paul McGuire MCIAT, ACIOB.
Chartered Architectural Technologist
46 Riley Park Kirkburton Huddersfield HD8 0SA
T. +44 (0)1484 602893 M. 07960 303343
E. info@pmcg-archtech.co.uk
Web. www.pmcg-archtech.co.uk



client VALLEY BOWMEN			
project PROPOSED INDOOR ARCHERY RANGE			
address THE ARCHERY FIELD OFF KNOWLE LANE MELTHAM			
drawing title SITE LAYOUT AS PROPOSED			
scale	prefx	drawing No	rev
1:200 @ A3	2020.00	(VB) SL 02	A

NOTES:

- disabled parking bay to be 6000mm x 3600mm in accordance with 'diag. 2 parking bay designated for disabled people' of the building regulations Approved Document part M2
- gradient of 1:25 to landing pad min. 1500mm x 1500mm to entrance doors

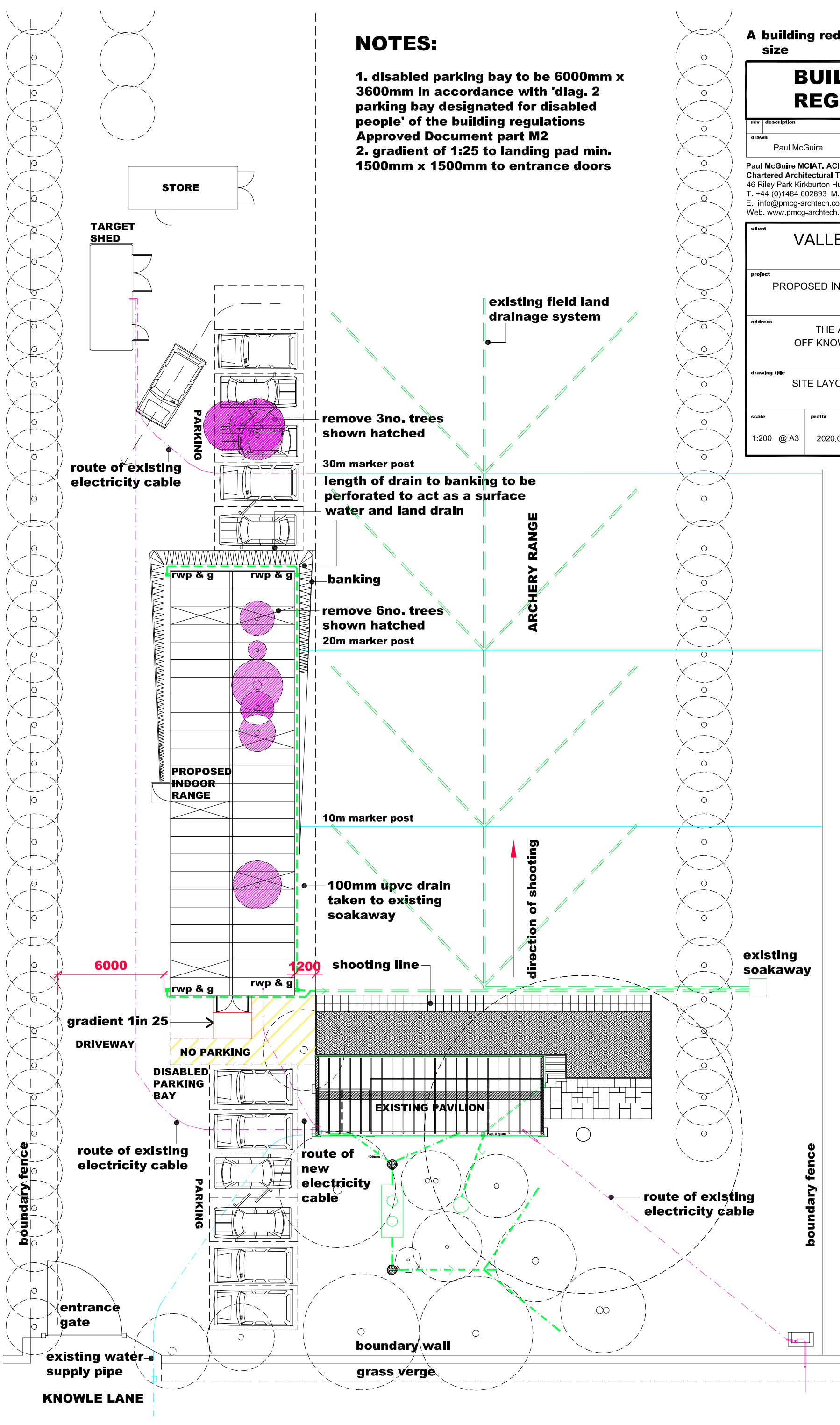

STORE

TARGET SHED

route of existing electricity cable

PARKING

remove 3no. trees shown hatched

30m marker post
length of drain to banking to be perforated to act as a surface water and land drain

existing field land drainage system

ARCHERY RANGE

banking

remove 6no. trees shown hatched
20m marker post

PROPOSED INDOOR RANGE

10m marker post

100mm upvc drain taken to existing soakaway

existing soakaway

6000

1200

shooting line

gradient 1 in 25

DRIVEWAY

NO PARKING

DISABLED PARKING BAY

EXISTING PAVILION

route of existing electricity cable

route of new electricity cable

route of existing electricity cable

boundary fence

boundary fence

entrance gate

existing water supply pipe

KNOWLE LANE

boundary wall

grass verge